

The Multi Channel Temperature Logger EBI 40:

Records temperatures during production development and process monitoring in baking stations, feed ovens and bakery ovens.

Current measurements can be read on the graphical display and the thermal insulation case of the EBI 40 allows high temperature usage.

Up to 12 temperature channels per temperature logger possible.



Multi Channel Temperature Data Logger

EBI 40-TC



Technical Data

Type	EBI 40-TC (Thermocouple)
Measurement range	-200 °C ... 1,200 °C
Accuracy	±0.5 °C (at 25 °C)
Resolution	0.1 °C (0.2 °F)
Channels	6 or 12 temperature channels
Sampling rate	Adjustable from 0.1 sec to 24 hours
Sensor	Thermocouple Type K / SMP connection
Operating temperature	0 °C ... +60 °C (0 °F ... +140 °F)
Storage temperature	0 °C ... +70 °C (32 °F ... 158 °F)
Memory	240,000 measurements (total)
Measurement mode	<ul style="list-style-type: none"> · Endless measurement immediately · Measure immediately until end of memory · Start / stop measurement
Display	TFT-display 3.5" (324 x 240 Pixel)
Dimensions (L x W x H)	140 x 118 x 35 mm
Housing material	ABS + PC
Protection class	IP 40
Certificate	Factory Calibration Certificate

EBI 40-TC



Applications

- Monitoring and validation of processes in incubators, refrigerators, freeze-rooms, storage rooms, transport studies etc.

Attributes

- | | | |
|---|---|---|
| <ul style="list-style-type: none"> • Up to 12 channels (thermocouple) • Current values shown on TFT-Display | <ul style="list-style-type: none"> • High accuracy • Different NiCr-Ni temperature sensors suitable | <ul style="list-style-type: none"> • Factory calibration certificate |
|---|---|---|

Description	Type	Part No.
6-channel (thermocouple)	EBI 40-TC-01	1340-6400
12-channel (thermocouple)	EBI 40-TC-02	1340-6401
EBI 40 wall mount	EBI 40-WH	1340-6431

Comments

See page 88 for accessories.

Accessories for EBI 40

Probes

We will find the perfect temperature probe for your applications, out of our extensive range of probes

- High quality thermocouples Type “K” (see page 10-19) e.g. wire, penetration, surface, magnet and micro probes.
- Magnets or brackets that do not affect the measuring performance

Wall mount EBI 40-WH

- Bracket for 35 mm cap rail

Thermal Isolation Box



- Sturdy thermal barrier (stainless steel and ceramic)
- Absolutely heat resistant insulation
- Replaceable sealing and cooling element
- Easy to transport
- Protects EBI 40 for 2 hours at 250°C
- Dimensions (with folded handles):
247 x 210 x 131 mm

1

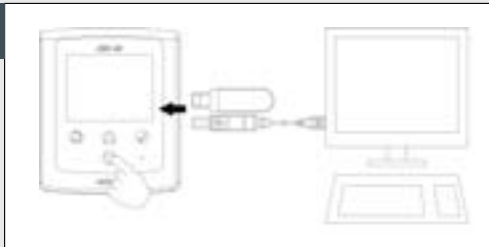

Program EBI 40 via keypad, USB stick or Winlog.pro

2

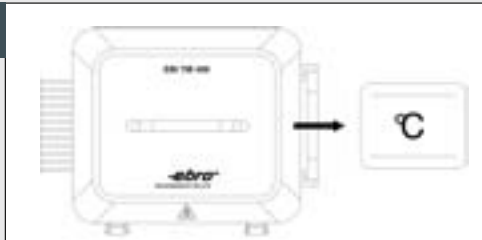

Place EBI 40 logger in thermal insulation box
EBI TIB 400-01. Run both trough process.

3

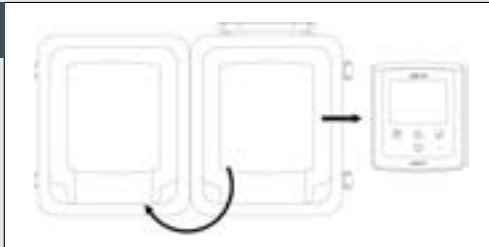

Open thermal insulation box and remove EBI 40.
Wait app. 0.5h for EBI 40 to cool down.

4

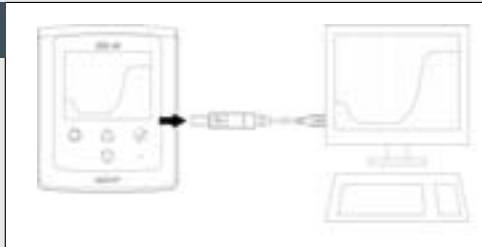

Measurement values can be inspected directly
on display or transferred via USB stick or cable
to Winlog.pro

Spare parts

Description	Type	Part No.
Thermal Isolation Box for EBI 40	EBI TIB 400-01	1340-6430
Blanket for Thermal Isolation Box	TIB-SEAL	7030-0143
Cooling element for Thermal Isolation Box	TIB-CE	7000-0103
EBI 40 wall mount	EBI 40-WH	1340-6431