

DI-1060SC

DIMENSIONS

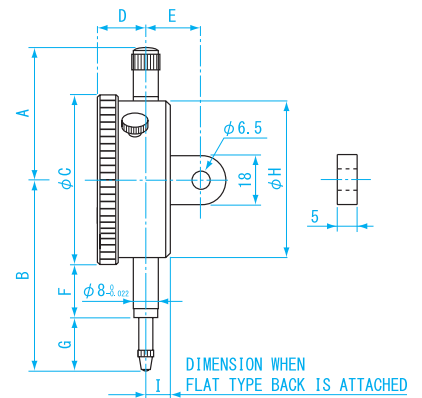

Units : mm

Model No.	A	B	C	D	E	F	G	H	I
DI-0560SC	45	67	60	16	20	18	19	55	9
DI-1060SC	45	67	60	16	20	18	19	55	9

- USE**
- Measuring surface flatness, checking tool set up, axial runout, checking squareness
- MATERIAL**
- Body : Steel
- FEATURES**
- Limit indicator clips included
 - O-Ring sealed between inner and outer lid to protect from water or oil
 - Jeweled bearings
 - White scale plate
 - Flat type back and center-lug back included.
 - Shock proof spindle mechanism protects the gear from abrupt motion.

Order No.	Model No.	Graduation (mm)	Measuring Range (mm)	Dial Reading (mm)	Backlash Error (μm)	Measuring Force less than (N)	1 Revolution (mm)	Indication Error 1/10 rev (μm)	Error over entire range (μm)	Repeatability (μm)	Weight
151671	DI-0560SC	0.01	0~5	± 0.100	3	1.5	1	8	± 12	3	125g
151672	DI-1060SC	0.01	0~10	± 0.100	3	1.5	1	8	± 14	3	125g

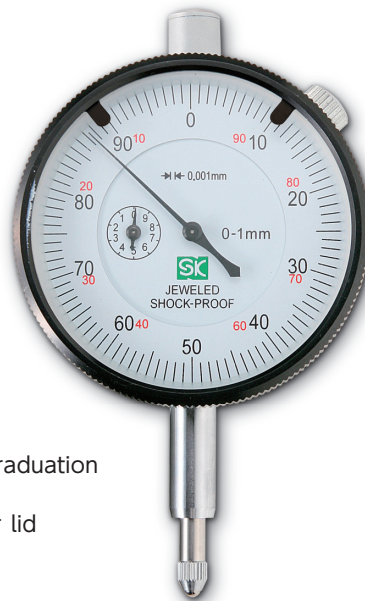

DIMENSIONS

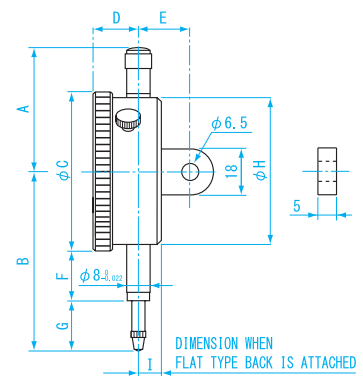

Units : mm

Model No.	A	B	C	D	E	F	G	H	I
DI-0160SC	40	61	60	16	20	18	13	55	9

- USE**
- Measuring surface flatness, checking tool set up, axial runout, checking squareness
- FEATURES**
- Body : Steel
 - Measuring Range: 0-10mm/ 0.001mm graduation
 - Limit indicator clips included
 - O-Ring sealed between inner and outer lid to protect from water or oil
 - Jeweled bearings
 - White scale plate
 - Flat type back and center-lug back included
 - Shock proof spindle mechanism protects the gear from abrupt motion.

Order No.	Model No.	Graduation (mm)	Measuring Range (mm)	Dial Reading (mm)	Backlash Error (μm)	Measuring Force less than (N)	1 Revolution (mm)	Indication Error 1/10 rev (μm)	Error over entire range (μm)	Repeatability (μm)	Weight
151670	DI-0160SC	0.001	0~1	± 0.100	2.5	3	0.1	3.5	± 5	0.4	145g